



POPCULTURA  
**BROGUM**

Technical specs



### **Contact**

Address: Julianastraat 46, 4301 NC, Zierikzee (NL)  
 Phone: +31 (0)111 450 127 (Monday-Friday 13:00-17:00h)  
 Email: [info@brogum.nl](mailto:info@brogum.nl)  
 Website: [www.brogum.nl](http://www.brogum.nl)

### **Hall specifications**

Capacity (hall): regular evenings max. 200 pers.  
 ( spec. events max. 400 pers.)  
 Audience (d\*w, area): 13.37 \* 9.12 m, 106m<sup>2</sup>  
 Stage (h\*d\*w, area): 0.8 \* 5.00 \* 9.00 m, 46m<sup>2</sup>  
 Drum Riser (h\*d\*w): 0.4 \* 2.00 \* 3.00 m

### **Backstage specifications**

(Un)loading Area (d\*w) 2.8m \* 4,0m  
 Backstage 1 (d\*w) 2.8m \* 4.0m + toilet, sink  
 Backstage 2 (d\*w) 2.8m \* 4.0m + toilet, shower, sink

### **Outdoor PR (on request):**

Banner size (h\*w): 1.0m \* 3.0m (landscape)  
 Poster boards (2pcs): A1 (portrait)



**Additional information**

- When arriving please park your car in a parking zone located at the rear side of the building. The (un)loading area blocks access to the main entrance and serves as a backstage emergency exit as well. So please when (un)loading occupy this area as short as possible.
- All backstage doors (including double stage doors) must be kept closed during sound check and show time.
- The venue has a smoking restriction in all areas, only outside the building smoking is allowed.
- Bottled drinks and hard liquor are prohibited in public areas. Please keep them backstage.
- Each backstage room has its own, fridge, table & chairs. Please keep this place clean & tidy.

**Important!****Sound levels are limited!****Respect our neighbors!****97 dBA (L Ar,LT )****Audio specifications****General purpose Audio system (Stage R):**

- Limiters: Dateq SPL2 (**trip point @ 0dB !**)  
Amps: JBSystems C3-1800 2x 450W (2ch mode)  
Speakers: 4x JBL JRX115 15" 500W  
Mixer: DAP Audio 4.1, 4ch line/mic+ eq +phantom
- Crossover: Behringer Super X-Pro crossover (low cutoff 32Hz - SUB - 120Hz - MIDHIGH)  
Amp Subs: SA900B 2x 425W  
Subs: 4x 15" back loaded scoop 500W

**General purpose Audio equipment (Bar):**

- Ethernet: Level One FSW1621, 16ports fast Ethernet switch  
Mixer: DAP Audio Compact 8.1, 8ch line/mic +phantom  
Mics: Omnitronik UHF500, 2x wireless microphone  
Radio: Sony ST-SE370  
CD player: Omnitronik CDP462, dual cd player.  
Laptop input: stereo 3,5mm jack  
Ext. input: stereo RCA

**Video: (fixed position in hall, for promotion purposes only)**

- Beamer: Benq HD1024p, VGA/HDMI.  
TV Screen: Panasonic 42" Full HD Plasma

**Front of House (Auditorium)****System One Audio "Focus 2" configuration**

TOP (L+R) System One Audio D-TOP3  
SUB (L+R) System One Audio D-SUB1  
SUB (Centre) 3X Hofman Audio B115

**FOH mix (Digital Digico D5)**

Mixer Digico D5 Live (NO SD!)  
Stage rack Digico MaDi (48 in / 40 out )  
USB int Digico UB MaDi

Monitors: 4\* System One Audio D-MON12  
Drum fill: 1\* Hofman B115 + 1\* Hofman T112

**Microphones & DI (other types, on request only)**

Voice 5\* SM 58 Shure (Dynamic)  
wireless 2\* GLXD24E/SM58 Shure (Dynamic Wireless digital)  
Instrument 2\* SM 57 Shure (Dynamic)  
Instrument 1\* SM 57 Beta Shure (Dynamic)  
Bass 1\* MB-6K Audio Technica (Condensor)  
Kick 1\* ATM250 Audio Technica (Condensor)  
Snare/ toms 5\* MB-5K Audio Technica (Dynamic)  
Overheads 3\* SE300B/CK91 AKG (Condensor)  
Direct inputs 7\* LBB-100 Klark Teknik Active DI

Extra: 2\*SM57B  
3\*MD421  
1\*D112

Mic stand low 4\* K&M  
Mic stand normal 10\* K&M  
Mic stand overhead 2\* K&M

**DJ SET: (Rental items, on request only)**

Mixer 1\* DJM-900 NXS2  
Players 2\* CDJ 2000 NXS2  
Turntables 2\* Pioneer SL1000

**Audio Power outlets (stage right)**

1\* 400V 32A CEE (MK/K1 3x25A)  
6\* CEE 16A 3pol Audio Power outlet for Backline/ monitors  
6\* Cable assembly CEE16A 3pol => 4x Schuko 1x Powercon

**General purpose power outlet (stage Right):**

4\* 230V 16A Shuko (OV1/G9,G10)



**Light specifications****Board: 1\*GrandMa 1 Fullsize****Conventional:**

Fronts 6\* theater spot Fresnel (500W)  
ACL 2\* aircraft: pair of 4x par 64 VNSP (250W/28V, 8pcs in series, 1ch \* 2000W)  
Par 24\* par 64 NSP (GX16D - 1000W/115V, 2pcs in series, 12ch \* 2000W)

**Intelligent:**

Color changers  
5\* Color Pro HXi CMY 6ch mode  
6\* Martin RobocolorPRO 400  
8\* Martin CX4 (HTI-150)  
7\* Martin Alien CMY  
Mirror heads 6\* Martin Roboscan 518 9ch mode  
Moving heads 4\* Showtech Phantom 50 LED Spot MKII  
Lasers 2\* Laserworld CS 1000RGB MKII

**Equipment:**

Hazer Antari ZM350  
Fogger Look Viper NT 230V  
Mirror Ball 50cm (DMX control: power on, rotation, down, up)  
Blacklight 3\* TL 36W, 120cm

**In Audience:**

16\* pin spot (low voltage 8pcs in series, 2ch )  
5\* par56 EuroLite LED RGB (20W)

**Dimmers (Rack mounted fixed system)**

1\* EuroLite DMX 4X, 4ch DMX splitter,  
1\* IES DMX to analog converter.  
2\* IES 6ch DMX analog dimmer (2500W/ch)  
1\* IES EXECUTOR 15AI, 6ch DMX dimmer (2500W/ch)

**Dimmers (loose pcs)**

8\* EuroLite EDX4 DMX, 4ch DMX dimmers (1500W/ch)  
3\* Showtec Multiswitch, 4ch DMX switchpack (max 1150W/ch, max 3680W tot)  
2\* Showtec Titan Strobe 1500watt (PX1500W)

**Light Power outlets on stage Left**

1\* 400V 32A CEE (MK/K2 3x25A)

**General purpose power outlet (stage Left):**

4\* 230V 16A Schuko (OV1/G7,G8)

Since we work with a fixed, non-patchable installation, not every request can easily be honored. If you have special requests for light effects, please contact us a few weeks ahead. Our engineers are willing to help you out, but are very limited in their spare time.



For additional information please contact [licht@brogum.nl](mailto:licht@brogum.nl)

**PLAN (ground level)**

**Electrical lay out:**

- MK: Main switchboard- 3xC80A
- OV1- 3x25A (entrance)
- OV2- 3x25A (kitchen)
- K1- 3x25A-Stage (audio)
- K2- 3x25A-Stage (light)
- K3- 3x63A (Anywave light)
- K4- 3x35A (not in use)
- K5- 3x35A (dimmer rack light)
- K6- 3x35A (Anywave audio)
- OV3- 3x25A (backstage)
- CEE1-3x25A (Anywave beer cooler)
- CEE2-3x25A (Anywave spare)

- OV1: (entrance)
- G1-16A Noodverlichting
- G2-16A Wagenshuur
- G3-16A MK
- G4-16A entree
- G5-16A toiletten
- G6-16A CV
- G7-16A (light)
- G8-16A (light)
- G9-16A (audio)
- G10-16A (audio)

- OV2: (kitchen)
- G1 pre cooler beer
- G2 outlets
- G3 chillroom, internet, storage
- G4 office on second floor
- G5 light kitchen, office, centr. heat/ hot water
- G6 dishwasher, tosti
- G7 bar TL, spot, wcd
- G8-spare
- G9-spare
- G10-spare
- G11 bar audio, wcd, beamer
- G12 hall spots, outside spots
- G13 ventilation, extraction
- G14 bar cooling units, coffee
- G15 main hall light TL

- OV3: (backstage (un) loading)
- G1-3x16A lights (un)loading
- G2-3x25A L1
- G3-3x25A L2

- L1: (backstage 1)
- G1 toilet (wcd, not in use)
- G2 heater shower, wcd (heating)
- G3 light, ventilation, wcd
- G4 not in use

- L2: (backstage 2)
- G1 emergency lights, outside entrance light
- G2 boiler
- G3 heater shower
- G4 lights, wcd
- G5 wcd (heating)
- S1 entrance side light

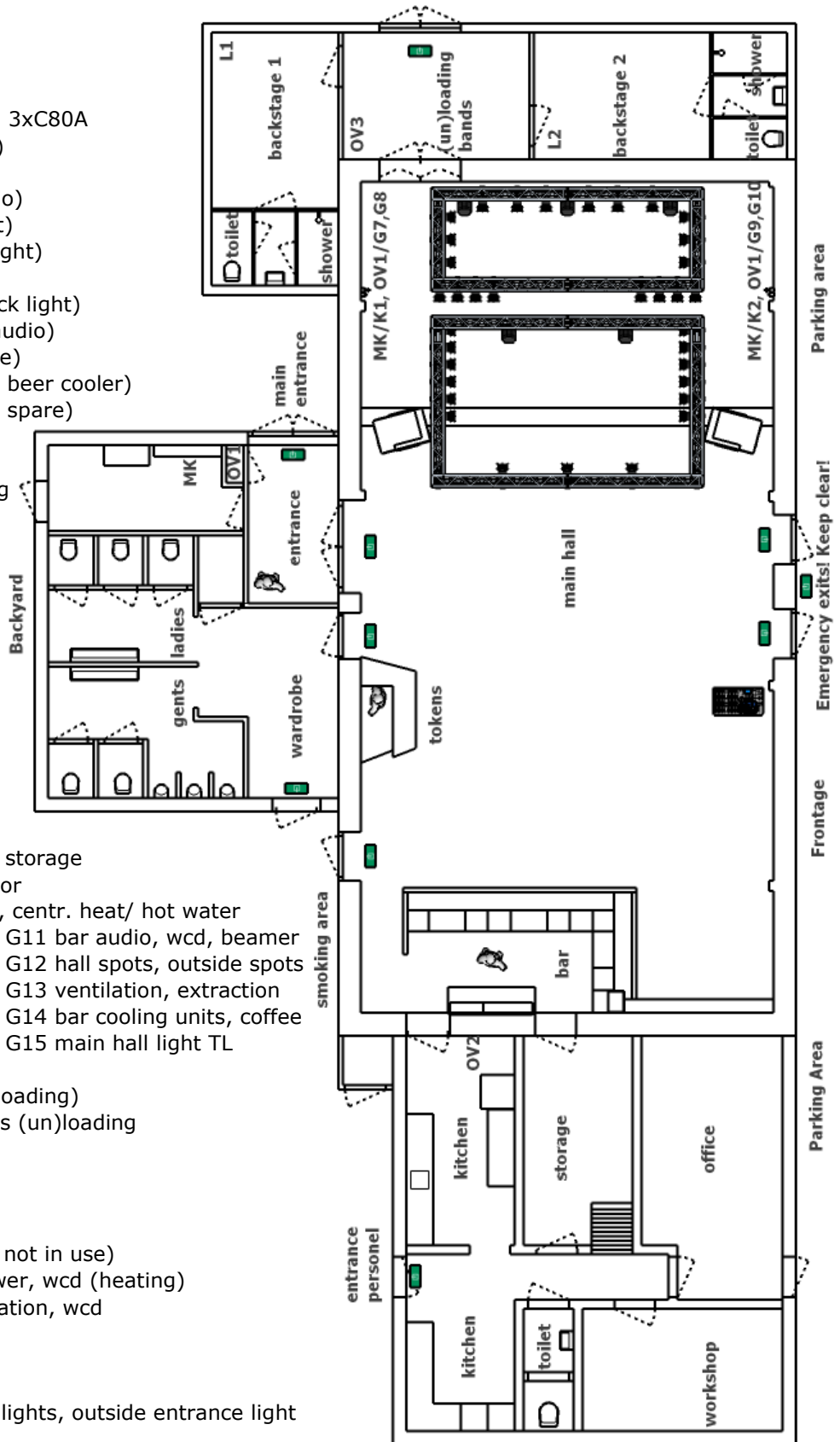

**PLAN (terrain)**

Brogum popcultura  
Julianastraat 46  
4301 NC Zierikzee  
the Netherlands  
+31 (0)111 450 127  
[www.brogum.nl](http://www.brogum.nl)  
[info@brogum.nl](mailto:info@brogum.nl)

BTW nr: NL005524131B01  
KVK nr: 41113359  
Bank: NL44 RABO 0137850328

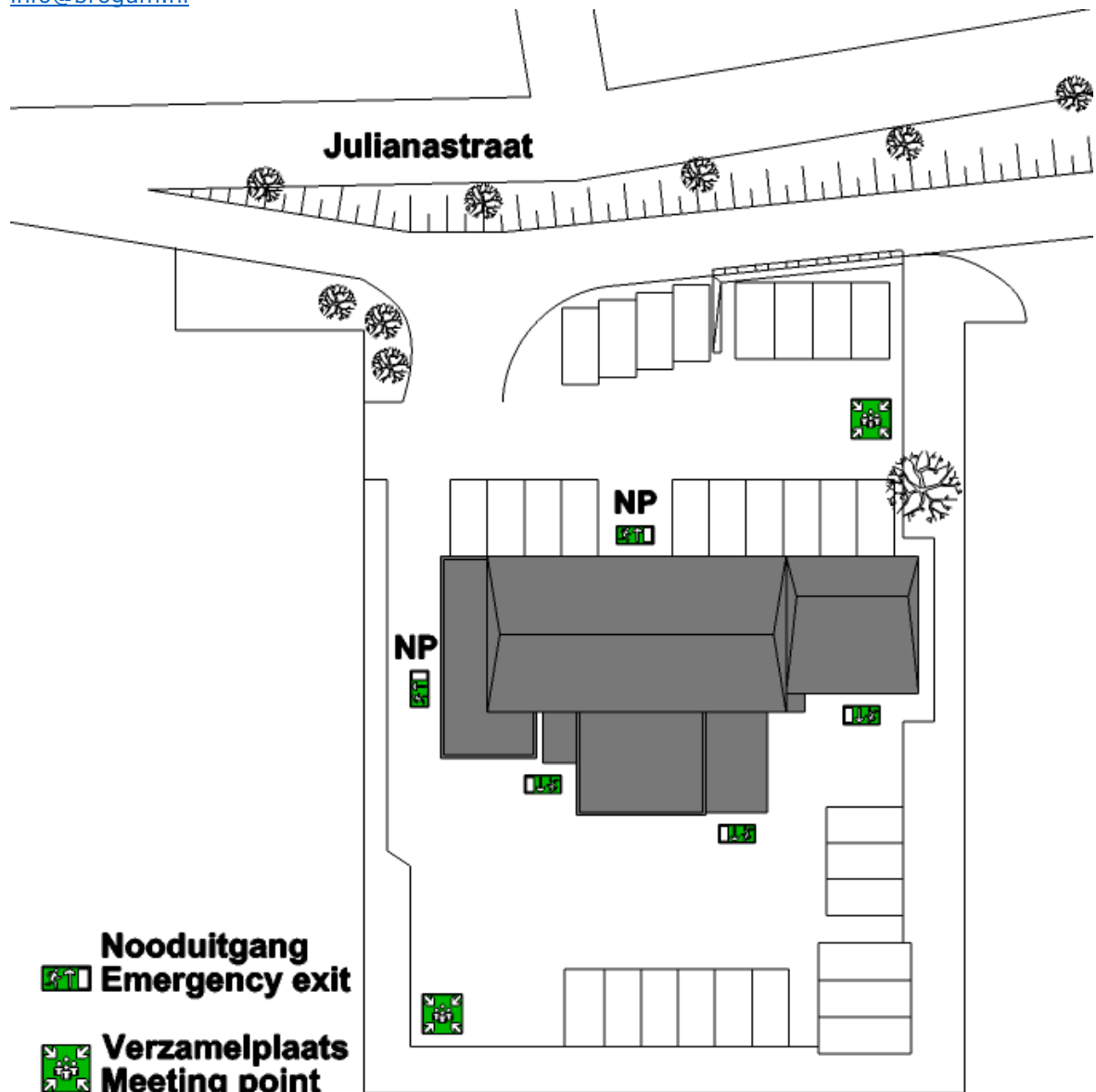

Terrain Brogum scale 1 : 500